

*ALL PIPES ARE DEAD HUNG . TRIM IS TO BOTTOM OF PIPE

LINE SET SCHEDULE

LS #	DESCRIPTION	PIPE TRIMS	SFT	GOOD SIZE
9	WHITE CYC	25" x 10 1/2"	490'W X 24'	11T
8	BLACK TRAVELER	26" x 6"	490'W X 25' x 12' x 12'	11T
7	SCENERY PIPE	26" x 6"	1/2"	
6	CYC LIGHT PIPE	26" x 6"		
5	3RD BORDER	31" x 1"	490'W X 8'	
4	1ST LEGS	26" x 6"	150" W X 23'	11T
3	2ND BORDER	31" x 1"	490'W X 9'2"	
2	SCENERY PIPE	26" x 6"		
1		339 3/4"	490'W X 11'	

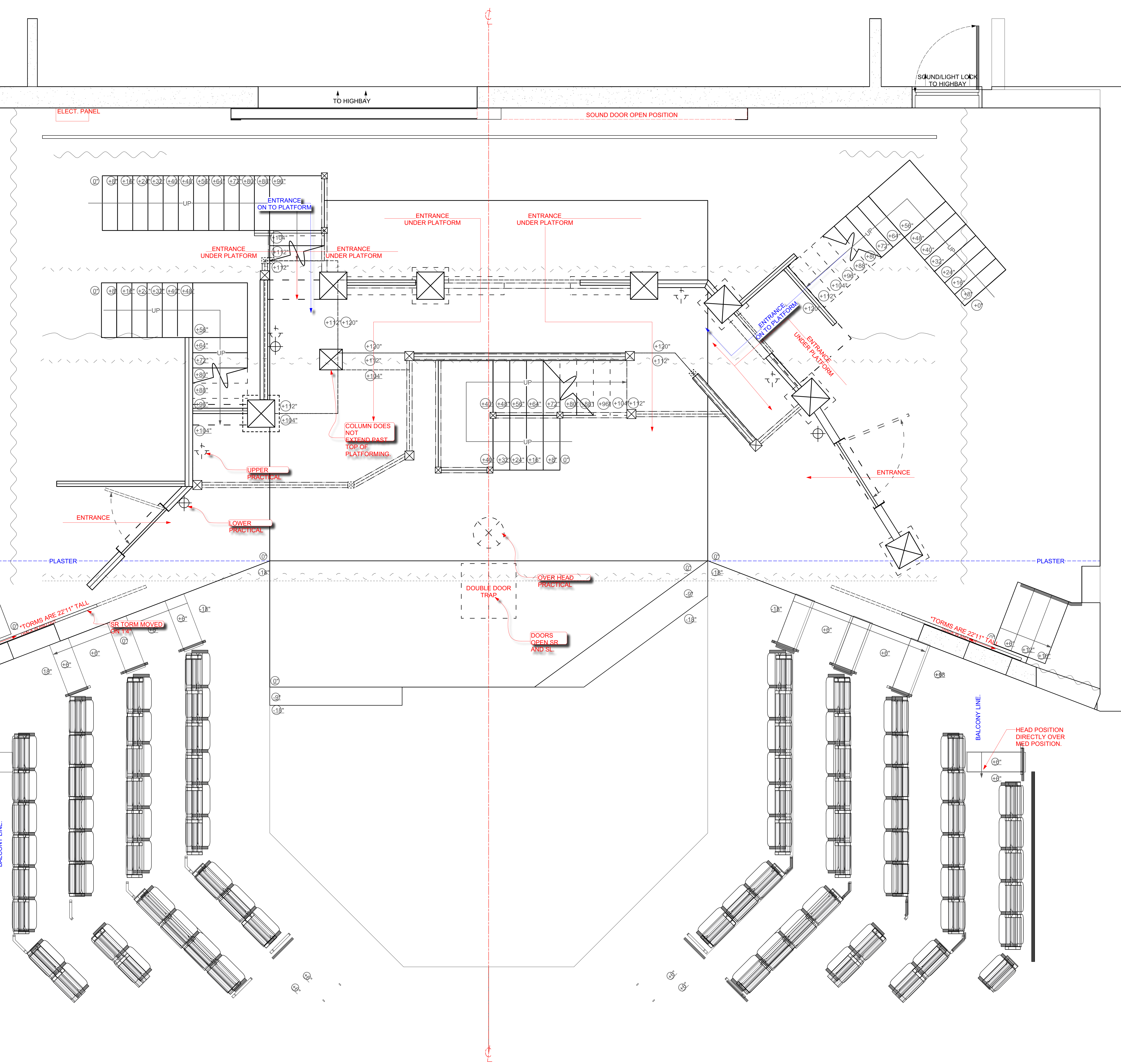

MACBETH

BY William Shakespeare
 DIRECTOR Miranda McGee
 SCENIC DESIGNER Justin N. Locke
 TECHNICAL DIRECTOR Elliott Hays-Wehle
 COSTUME DESIGNER Rainy Edwards
 SOUND DESIGNER Doug Borntreger
 LIGHTING DESIGNER Justin N. Locke
 PROJECTIONS DESIGNER DEBRA KING

MAC GP

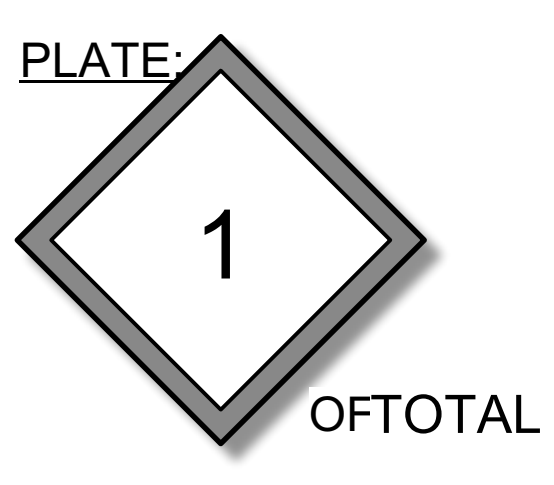

SCALE 1/2" = 1'0"
 REV./# DATE NOTE
 A 1/1/2019 PRELIM.

NOTES:

- ALL WALLS THAT MEASURE 3 1/2" CAN BE ADJUSTED TO STOCK WIDTH. SIZE DETERMINED BY TD.
- WALLS THAT ARE MEASURED TO BE 5" THICK ONLY HAS TO BE 5" ALONG SIDES AND TOPS.
- DOORS ARE ALL FUNCTIONAL AND HARDWARE WILL BE CHOSEN BY DESIGNER. (PLEASE GIVE \$200 ALLOWANCE FOR HARDWARE.)
- ALL HANDRAILING THAT IS DRAWN IN WILL BE DESIGNED BY DESIGNER.
- THE TOP HALF OF THE SR ESCAPE STAIRS WILL BE DESIGNED BY DESIGNER. THE SL ESCAPE STAIRS CAN BE PULLED FROM STOCK.
- ALL PRACTICALS WILL BE A COLLABORATION BETWEEN PROPS AND SCENIC. PLEASE DISCUSS WITH DESIGNER.
- PLEASE DOUBLE CHECK ALL STAIR MEASUREMENTS.
- ALL SILHOUETTE LOCATIONS ARE LABELED. PLEASE DISCUSS CONSTRUCTION OF WALLS WITH SD AND LD.
- SURFACE TEXTURE IS STILL BEING DISCUSSED BETWEEN SD AND PROJECTIONS DESIGNER.
- PLEASE DISCUSS TRAP DEPTH WITH SD.
- TRIM OF OVER HEAD PRACT. WILL HAVE TO BE DETERMINED DURING INSTALL.